



*Live
blessed!*



"yadā yadā hi dharmasya
glānirbhavati bhārata
ābhyutthānam adharmasya
tadātmānaṃ sṛjāmyaham

paritrāṇāya sādhūnāṃ
vināśāya ca duṣkṛtām
dharmasaṃsthāpanārthāya
saṃbhavāmi yuge yuge."

—(Bhagavad Gita: Chapter Four verse 7 and 8)

Sri Krishna said in the Bhagavad Gita: "Whenever and wherever there is a decline in virtue/religious practice, O Arjuna, and a predominant rise of irreligion – at that time I descend Myself, i.e. I manifest Myself as an embodied being. To deliver the pious and to annihilate the miscreants, as well as to reestablish the principles of religion, I Myself appear, millennium after millennium."

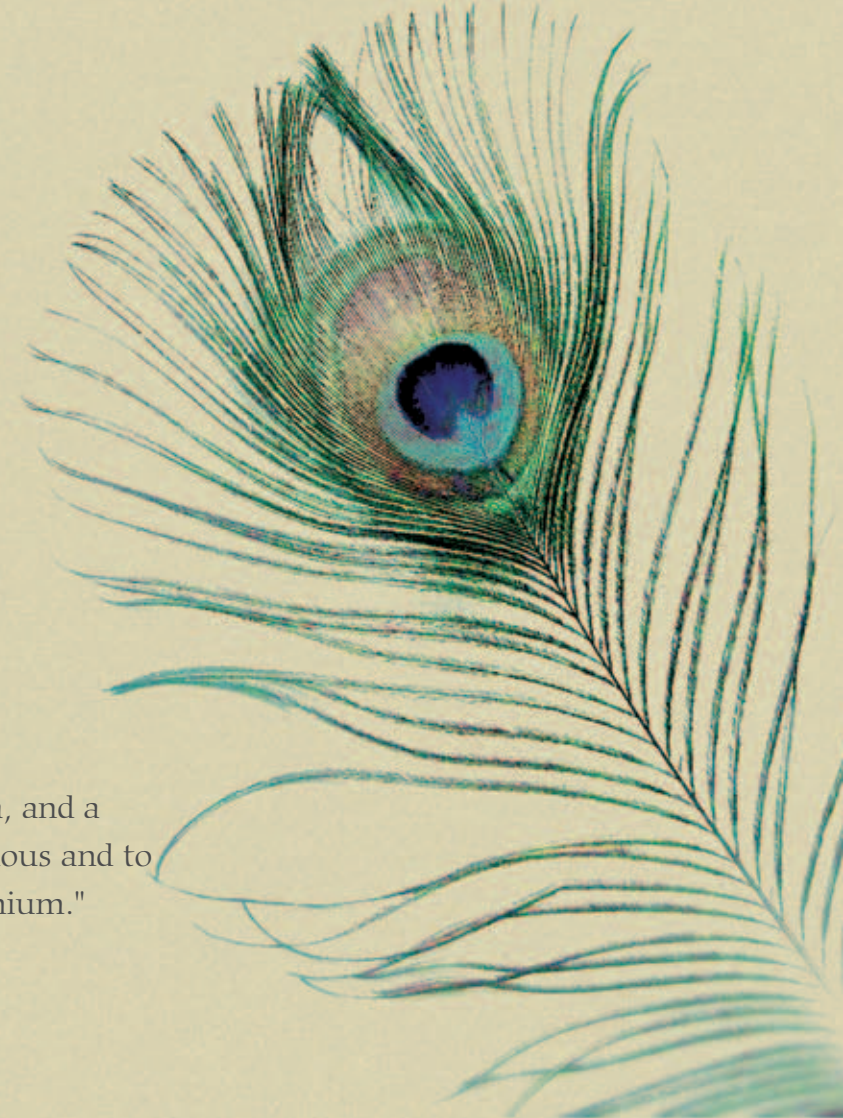



Vrindavan the name that instantly evokes the image of Lord Krishna. Situated south east of Delhi in the Mathura district of UP in north India. Vrindavan is widely acknowledged as the place of Krishna's childhood. It is one of the most frequented holy towns in the Indian sub continent.

Srimad-Bhagavatam describes the extraordinary pastimes Krishna performed in Vrindavan during his childhood. The *Bhagavad Gita* explains that Vrindavan on earth is a replica of Krishna's everlasting residence in the spiritual world. And the *Brahma-samhita* says Krishna is eternally living in Vrindavan.



Welcome to Vrindavan

Exist in a state of perpetual union
with Lord Krishna



Introducing



An opportunity to reside in a grand township that not only offers world-class living spaces, but is also immersed in love and devotion to Lord Krishna.

Right at the feet of Vrindavan Chandrodaya Mandir, the world's tallest Krishna temple.

Aesthetically planned, with every apartment overlooking lush greens, an apartment at Krishna Bhumi is much more than just four walls. The entire initiative stems from the idea of creating the possibility of existing in a state of perpetual union with Lord Krishna.



location

On Bhaktivedanta Swami Marg (Chhatikara Road), in the heart of Vrindavan.

Nearby destinations

- Maa Vaishno Devi Dham: 1 km
- Prem Mandir: 2 km
- ISKCON Temple: 2.5 km
- Bankey Bihari Temple: 4.5 km
- Radha Ballabh Mandir: 4.5 km
- Nidhivan: 4.5 km
- Gopinath Temple: 4.5 km
- Madan Mohan Temple: 4.5 km
- Holy Yamuna River: 4.5 km
- Rangnath Temple: 5.5 km
- Govardhan: 22 km

Connectivity

- NH2 (Delhi-Agra): 2 km
- Vrindavan Rly. Stn.: 3 km
- Yamuna Expressway: 12 km
- Mathura City: 10 km
- Mathura Rly. Stn.: 11 km
- Delhi Airport: 160 km





A skyscraper temple of Lord Sri Krishna

Project conceived by devotees of:



Krishna Theme Park



Indoor Krishna Lila Park



The Grand Temple Hall



Dvadasha Kanana - the 12 recreated forests



Vrindavan Chandrodaya Mandir
at 700 feet will be the tallest
Krishna temple in the world.

- Conceived by devotees of ISKCON-Bangalore.
- The iconic temple spans 5 acres.
- It houses the grand temple hall with Sri Radha Vrindavan Chandra Mandir along with the Sri Chaitanya Mahaprabhu Mandir and Srila Prabhupada Mandir in different wings.
- It also features a Krishna Heritage Museum, study centre, festival and lecture halls and a viewing gallery at 700 feet.
- Added attractions include a vedic cosmology exhibit and a massive indoor Krishna Lila Park with boat rides.

master plan



at the feet of Vrindavan Chandrodaya Mandir

apartments & villas

Luxury Villas come in a range of 3-5 BHK, to suit different needs & styles.



Shyam Kutir

Plot size - 4,306 sq. ft
Villa size - 4,502 sq. ft



Keshav Kutir

Plot size - 2,519 sq. ft
Villa size - 2,992 sq. ft



Gopal Kutir

Plot size - 1,399 sq. ft
Villa size - 1,786 sq. ft



*apartments at
govardhan vas*

Select apartments from a range of Studio, 1, 2 and 3 BHK at Govardhan Vas configured over G+14 residential towers.



Family Lounge



Master Bedroom



Live blessed



A grand township in Vrindavan that offers world class living spaces adjacent to the world's tallest Krishna temple amidst acres of greenery and well manicured sprawling stretches. It is a place to be one with God and nature.



For the convenience of the elders in the family there will be doctors and nurses on call, diagnostic and medical centre. We are also providing ramps for easy access to all parts of the building.



At Krishnabhumi, besides your spiritual well being, there is also a world class Spa & Ayurveda for you to indulge in.



The gated community will have 24 x 7 security and CCTV surveillance for the safety of all residents and their guests.



For your daily requirements we are providing a convenience store within the residential complex.

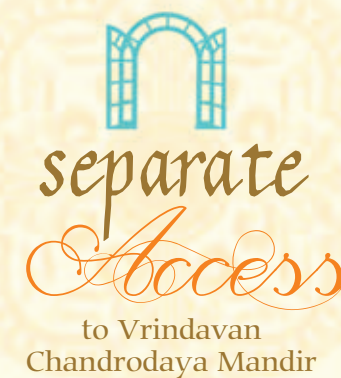

There will be a separate exclusive access to the temple for all Krishna Bhumi residents. Also on festival days, they will have a dedicated queue.



An inhouse lifestyle and wellness club equipped with all modern amenities will take care of rejuvenation and recreational needs of each family member. The Food Court will host a menu that will keep the taste buds satiated.

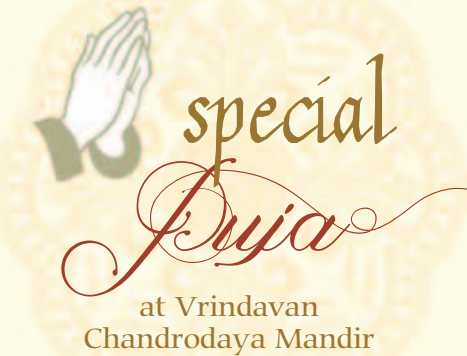

Every apartment owner will get a special puja every year on the date of their choice.



There will be ample parking for all residents and guests.



Avail of our complimentary coach service for *darshan* at Bankebihari temple, ISKCON temple and Prem mandir.



Live blessed



Vast green area



Swimming pool



Outdoor games



Club



High security and surveillance



Laundromat



Food court



Convenience store



Spa and Ayurveda



Gymnasium



Elder care



Diagnostic and medical centre



Special *pooja* & entry to Mandir



Coach service for *Darshan*

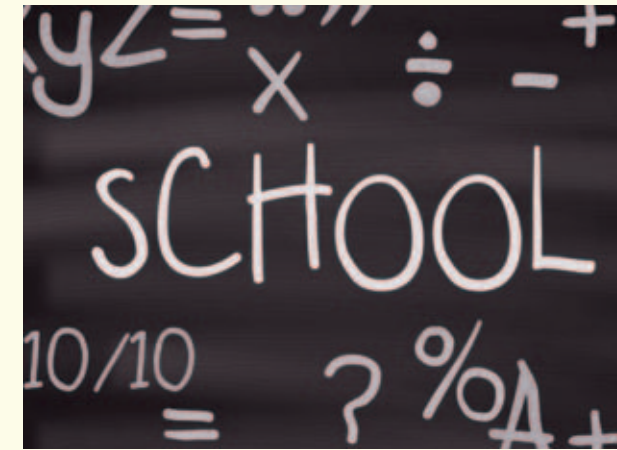

School



Hotel apartments



1st, 3rd, 5th, 7th, 9th, 11th & 13th Floors



2nd, 4th, 6th, 8th, 10th, 12th & 14th Floors



Alternate plan with
study attached





Alternate plan with
study attached



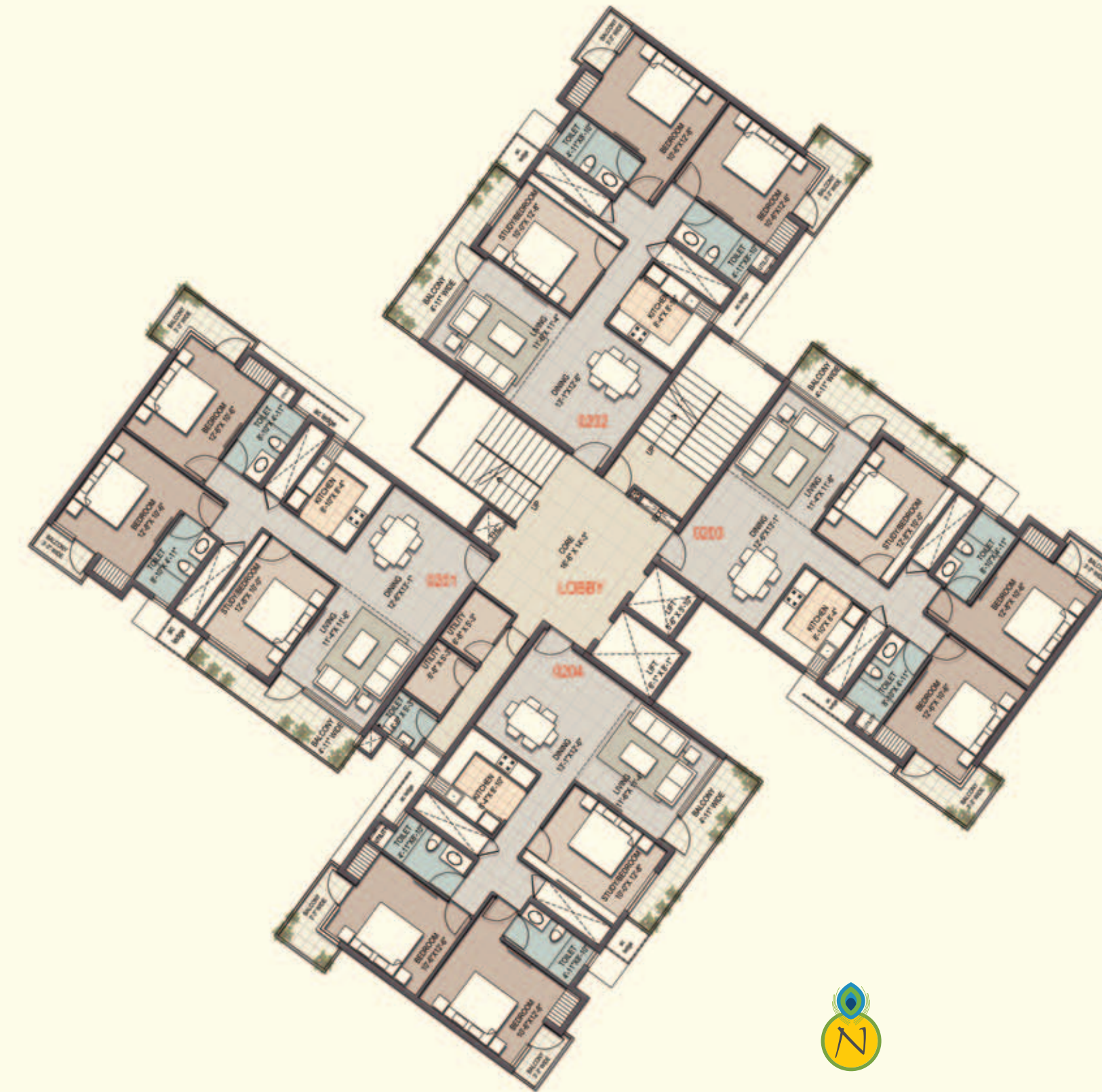

Alternate plan with
study attached



specifications

Structure

- RCC Framed structure designed in compliance with seismic forces and foundation fulfilling

Wall Finish

- **External:** Exterior Grade Paint / Texture Paint / Equivalent
- **Internal:** Emulsion Paint on POP including ceiling / Equivalent

Elevators

- 2 elevators per tower provided

Flooring

- **Living & Dining:** Vitrified Tiles
- **Bedrooms:** Vitrified Tiles
- **Kitchen:** Anti-skid Tiles
- **Toilets & powder Rooms:** Anti-skid Tiles
- **Balconies and terraces:** Matt finish / Anti-skid Ceramic Tiles

Doors and Windows

- **Main Door:** Polished wooden frame with polished flushed door shutters /Equivalent
- **Internal Doors:** Painted wooden frame with painted flushed door shutters / Equivalent
- **Windows:** Aluminum or UPVC frame windows with Glass / Equivalent

Kitchen

- **Counter:** Granite counter top with Stainless steel sink
- **Dado:** Ceramic tile dado
- **General:** Provision for water purifier

Toilets

- **Wall Finishes:** Glazed /Matt finish ceramic tile dado
- **Fixture and Fittings:** Sanitary ware, CP fittings and accessories of good quality

Electrical

- **Wiring:** Concealed copper wiring
- **Lighting and Fan Outlet:** Adequate provision of points for Lights, fans and plugs in Living & dining, Bed Rooms, Kitchens and toilets
- **AC power outlet:** All bedrooms and living and dining
- **Geyser power outlet:** All toilets and kitchen
- **Exhaust fan outlet:** All toilets and kitchen
- **TV and Telephone outlets:** In living dining and master bedroom
- **Internet Provision:** Provision in the apartment
- **Switches:** Modular switches of reputed brand
- **Power Back up:** Adequate power back up

Lift Lobbies

- **Ground Floor Entrance Lobby:** Combination of Granite and Vitrified tiles / Equivalent
- **Upper Floor Lobbies:** Vitrified tiles
- **Staircase:** Polished Indian Stone

Security

- **General:** Intercom System and CCTV cameras

Interior Upgrades

- Interior finish upgrade options to be available in due course



Our journey started in 2000 with ‘Think Tank’ which is considered today to be a first of its kind, Intelligent IT infrastructure of Eastern India. Since then, there have been a slew of inspiring IT infrastructure projects such as *Infinity Benchmark including Infinity Business Centre, *Godrej Waterside, and *Infinity IT Lagoon, each bearing the signature Infinity stamp of being green, intelligent and crafted with care for tomorrow.

From IT infrastructure, our tryst has taken us to the realm of residential and other commercial developments as well. Some of our upcoming projects include green townships in Assam called

*Signature Estates and Infinity Heights, *Infinity Greens and Infinity Sapphire Square in Ranchi, Mayavan & the very iconic Krishna Bhumi in Vrindavan, to name just a few.

At Infinity, we take our Corporate Social Responsibility very seriously. Giving back to society and nation building is both our commitment and passion. To this effect, we have taken up the cause and mission of expanding the opportunity of education for meritorious students through Anant. We have also been long standing partners and supporters of The Akshaya Patra Foundation, The Jaipur Foot, Vedanta Academy, Eye Care & Research Centre, Institute of

Neurosciences – Kolkata, Manovikas Kendra, National Academy of Environment, Matri Bhavan & so on. We are also building a first of its kind, senior citizens’ home at Ibiza Club, Kolkata called ‘Jagriti Dham’.

At Infinity, we truly believe and are driven by the maxim, ‘Possibilities Infinite!’

**Infinity Benchmark – USGBC certified Platinum rated Green Building – 7th in the world and 2nd Outside USA*

**Infinity IT Lagoon – IGBC Platinum Pre-certified (Core & shell)*

**Godrej Waterside – Gold rated IGBC certified Green Building*

**Infinity Greens – Gold rated IGBC Pre-certified Green Homes*

**Signature Estates – Gold rated IGBC Pre-certified Green Homes*



An initiative of

infinity

For further details contact:

Vrindavan:

Krishna Bhumi
Bhakti Vedanta
Swami Marg
(Chhatikara Road),
Vrindavan - 281121,
Uttar Pradesh

Agra:

Sumriddhi
Business Centre,
Block No - 38/4A,
Sanjay Place,
Suite No - 2, 3rd Floor,
Agra - 282002

Delhi:

Premises No - C-96,
Ground Floor
Sector - 2, Noida
District - G.B Nagar
U.P. - 201301

Kanpur:

Office No 207
2nd Floor,
Kalpana Plaza
Birhana Road
(Near K.P.M. Hospital)
Kanpur - 208001

Kolkata:

Snowwhite
Infrastructure Pvt Ltd
Infinity Tower II,
16th Floor,
Sector V, Salt Lake,
Kolkata - 700059

Co-ordinates:

+91 9696968899, +91 9555655000 (Delhi), +91 9831421216 (Kolkata), +91 5623216162 (Agra)
info@krishnabhumi.in, www.krishnabhumi.in

Follow us on:



Disclaimer: The contents of this material are conceptual and may / may not form part of the final product. We reserve the right to change and modify the contents without prior notice and shall not be liable to anyone for the changes / improvements made.

